



ESTATE & LETTING AGENCY



23 Lound Road

, Sheffield, S9 4BJ

£340,000



4



0



1





Floor Plan



Area Map



Energy Efficiency Graph



Viewing

Please contact our Ready Steady Move Sales Office on 0114 395 1722 if you wish to arrange a viewing appointment for this property or require further information.

- NEW DEVELOPMENT
- DETACHED PROPERTY
- FOUR BEDROOMS
- DOWNSTAIRS W.C
- MASTER BEDROOM WITH EN-SUITE
- ENCLOSED REAR GARDEN
- OPEN PLAN KITCHEN/DINER
- FREEHOLD
- 10 YEAR GUARANTEE



Ready Steady MOVE are delighted to market this delightful development in the popular postcode of S9. The property is located close to local amenities and fantastic transport links to Sheffield as well as Meadowhall and Don Valley.

This eagerly awaited four bedroom detached property which will be finished to a high standard throughout by this respected local builder comprises of a bay-windowed lounge, an open-plan dining kitchen and features Bi-Fold doors leading to the garden and has a downstairs W.C.

To the first floor of the property is a double bedroom, a further bedroom/study and a bathroom.

To the first second floor of the property there is a master bedroom with an en-suite and a further double bedroom.

At the front of the property is a driveway with ample parking and at the rear is a enclosed garden perfect for entertaining.

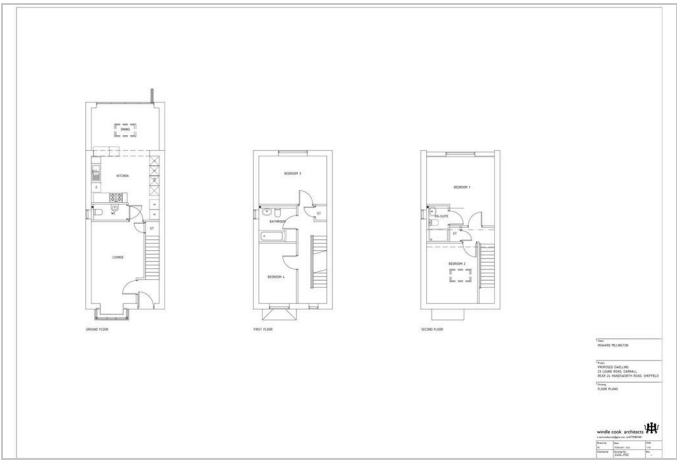

These particulars, whilst believed to be accurate are set out as a general outline only for guidance and do not constitute any part of an offer or contract. Intending purchasers should not rely on them as statements of representation of fact, but must satisfy themselves by inspection or otherwise as to their accuracy. No person in this firms employment has the authority to make or give any representation or warranty in respect of the property.